

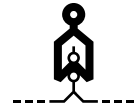



SAS150

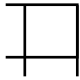

A highly versatile and easily maintained clip-in suspended ceiling system with convenient hinge-down access and secure void option.

SYSTEM GROUP	GRID
	
Suspended ceiling	Concealed Grid – SAS shallow or deep Omega Bar

TILE	
	
Clip-in	Bevelled edges Closed butt-joints

ACOUSTICS	
0.4 - 1.0	15-41dB
NRC	Dnfw*

ACCESS	SYSTEM WEIGHT	LIFE EXPECTANCY
	1.8lbs/ft² Approx.	25yr
Full – hinge and slide tiles	Based on 2' x 2' tiles	In excess of

*Note SAS products are tested in accordance with UK standard Dnfw this means CAC will be 2-2.5dB greater. For more information, please see page 19

SAS PLUS

HAVE A QUESTION?

Configurable with other products. Call us.
Contact us on enquiries@sasint.us

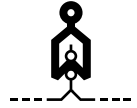

SAS150 offers all the benefits of SAS120, with the additional convenience of hinge-down access minimising risk of damage. Clip-in systems allow for upward cleaning pressure without dislodging or displacing tiles. If required, voids can be secured through the use of a simple clip mechanism.

Hospitals and food preparation areas are ideal examples of appropriate environments, however the system is suitable for numerous applications.

Module Sizes (inches) with nominal 1/8" bevel

2' x 2'

2' x 4'

Bespoke module sizes and shapes are available on request.

Access

Hinge down and slide – The void is completely accessible with the use of a simple tool.

Alternatively, in areas where security is paramount optional security clips are available. This restricts access to the void to minimise security concerns.

Finishes

SAS150 is available in all standard SAS finishes, please refer to page 110. Bespoke finishes are available on request.

Perforations

Typically supplied with 1522 (available as stock item), 1820 or 2516. For our full range of perforations, please refer to page 84. Bespoke perforations are also an option.

Acoustic Materials

Acoustic mineral wool pad with black tissue face, foil back and sides. Other acoustic materials are available, please refer to page 17.

Please note SAS150 is not suited to all SAS acoustic materials due to maximum loads on clip-in systems.

Service Integration

Tiles can be formed with apertures during manufacturing and post painted for integration with lights and other services.

Please note SAS tiles will support loads up to 5.5lbs. SAS pattresses can be used to support loads up to 13lbs. Anything in excess of 13lbs requires independent suspension.

Technical Support

Please contact our technical team for all questions relating to access, security, bespoke features, acoustics, service integration or load support.

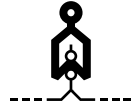

Perspective Drawing

- 1 Emac Hanger
- 2 Omega Bar to Channel Bracket
- 3 Emac Channel
- 4 SAS Omega Bar
- 5 Emac Wall Anchor
- 6 Omega Bar Splice
- 7 Perimeter Trim
- 8 Perimeter Wedge
- 9 SAS150 Tile

*Lightweight installations only, see page 247 for full details.

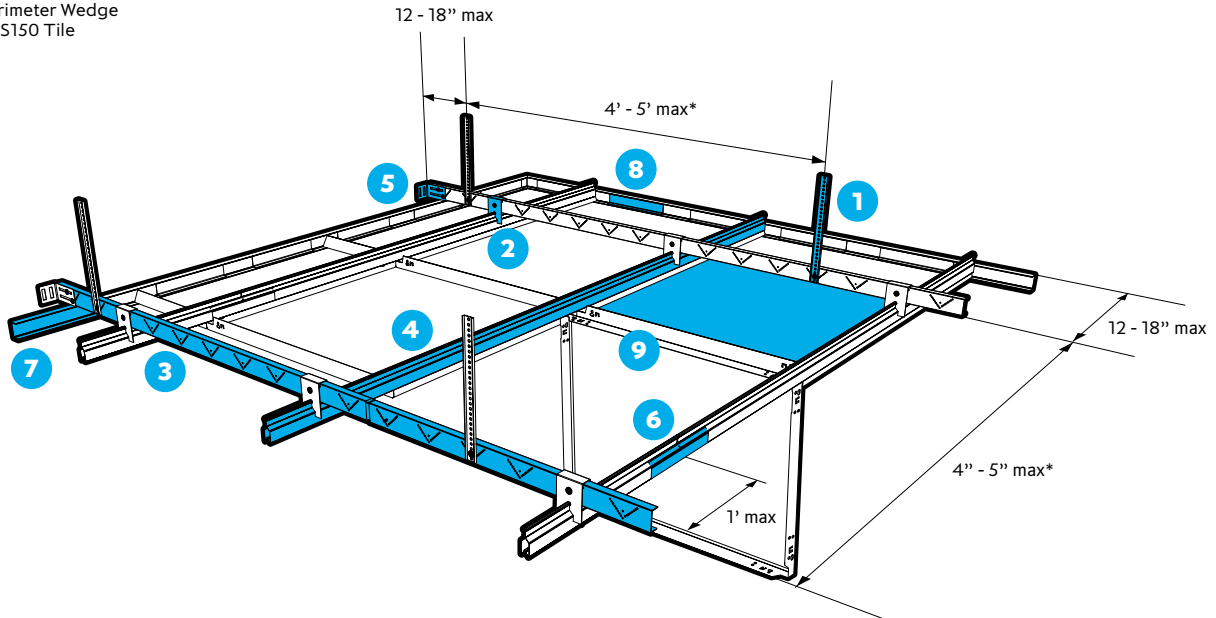

Section and detail drawings

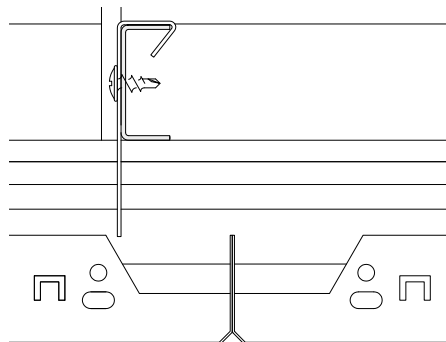
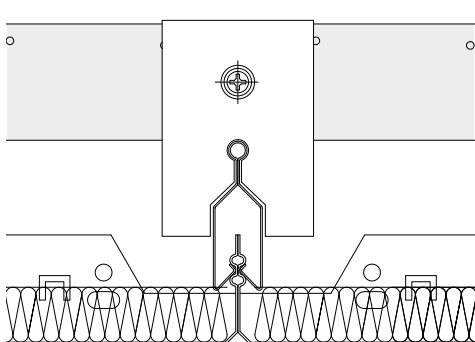
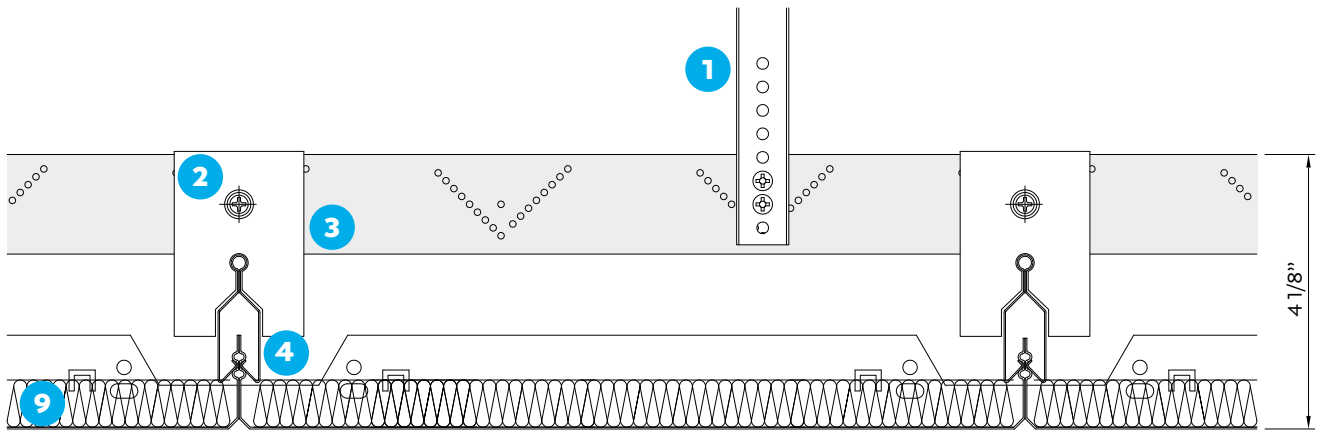

SAS150 | Features

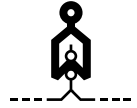

Hinge and Slide Facility



SAS150 allows every full tile to pivot and slide along the grid system. This feature facilitates easy access to large areas of the ceiling void for maintenance. Tiles are retained within the ceiling grid avoiding damage and eliminating the need for storage.

Service Integration



Other services can be integrated with SAS150. Modular lighting can be supported directly from the soffit. Where maximum point loads are exceeded (5lbs) the service must be supported independently or from the grid.

Loads in excess of 5lbs and up to 13lbs can be supported by an SAS Pattress. This distributes the load across the SAS Omega Bar and eliminates the need for complicated support arms. Loads in excess of 13lbs must be supported independently. For more information on load support, please contact our technical design department.

Bulkhead Closure Panels

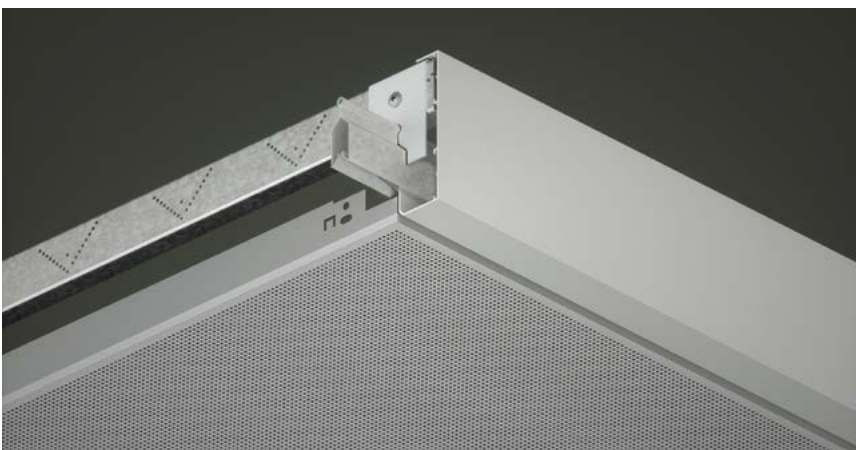

Bulkhead closure panels enable floating rafts and ceilings to be created using a standard clip in ceiling tile. The height of the closure panels can be manufactured to suit project requirements. For more information on closure panels, please contact our technical design department.



SAS**150**

DNO Office

Location
Dubai, UAE
Architect
**Cambridge
Consultants**

Contractor
n/a
Purpose
Commercial

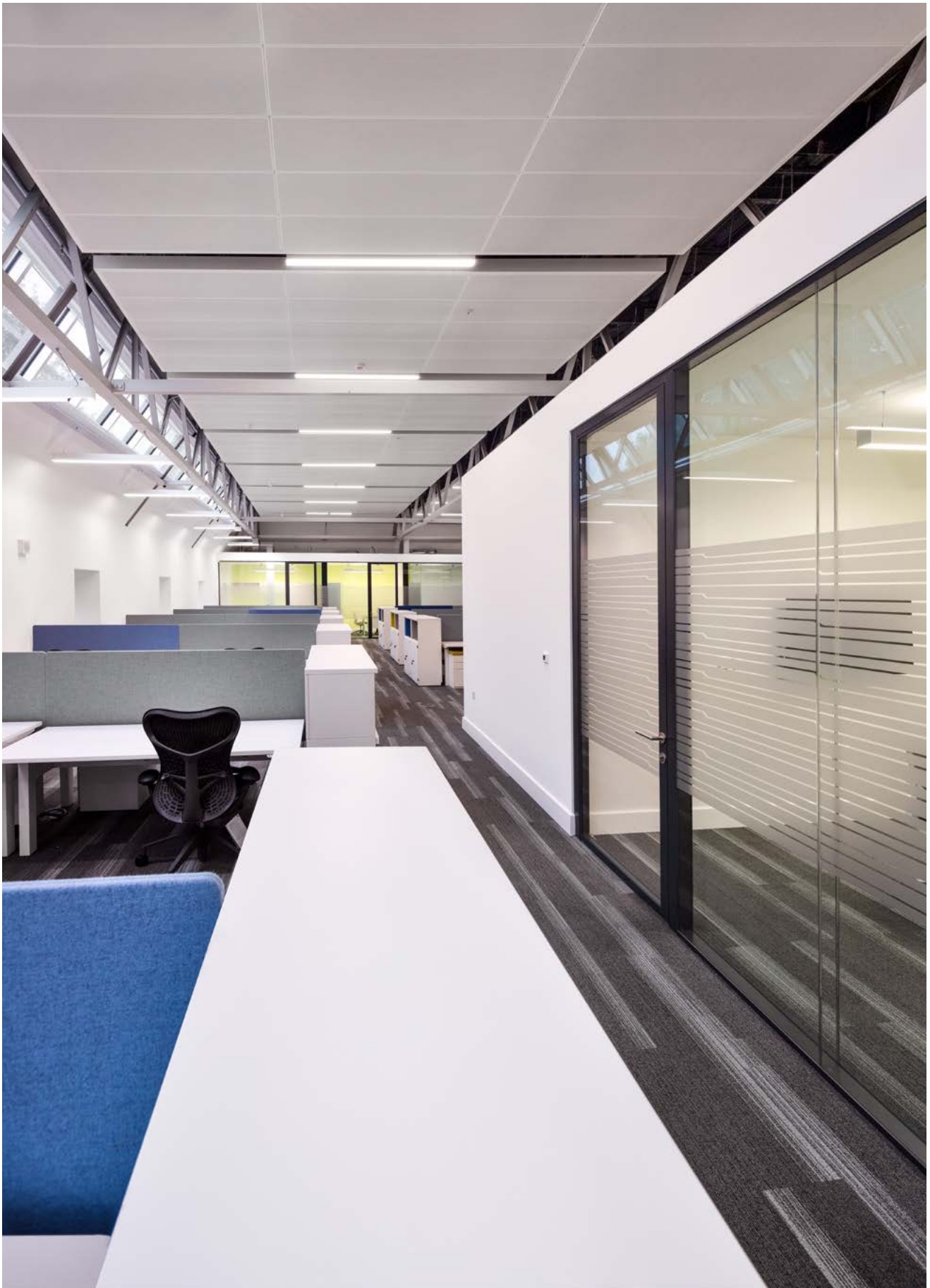

SAS**150**

Boston Scientific Cork

Location
Cork, Ireland
Architect
**Butler Cammoranesi
Architects**

Contractor
John Sisk & Son
Purpose
Commercial