

Arizona State University *CASE STUDY*

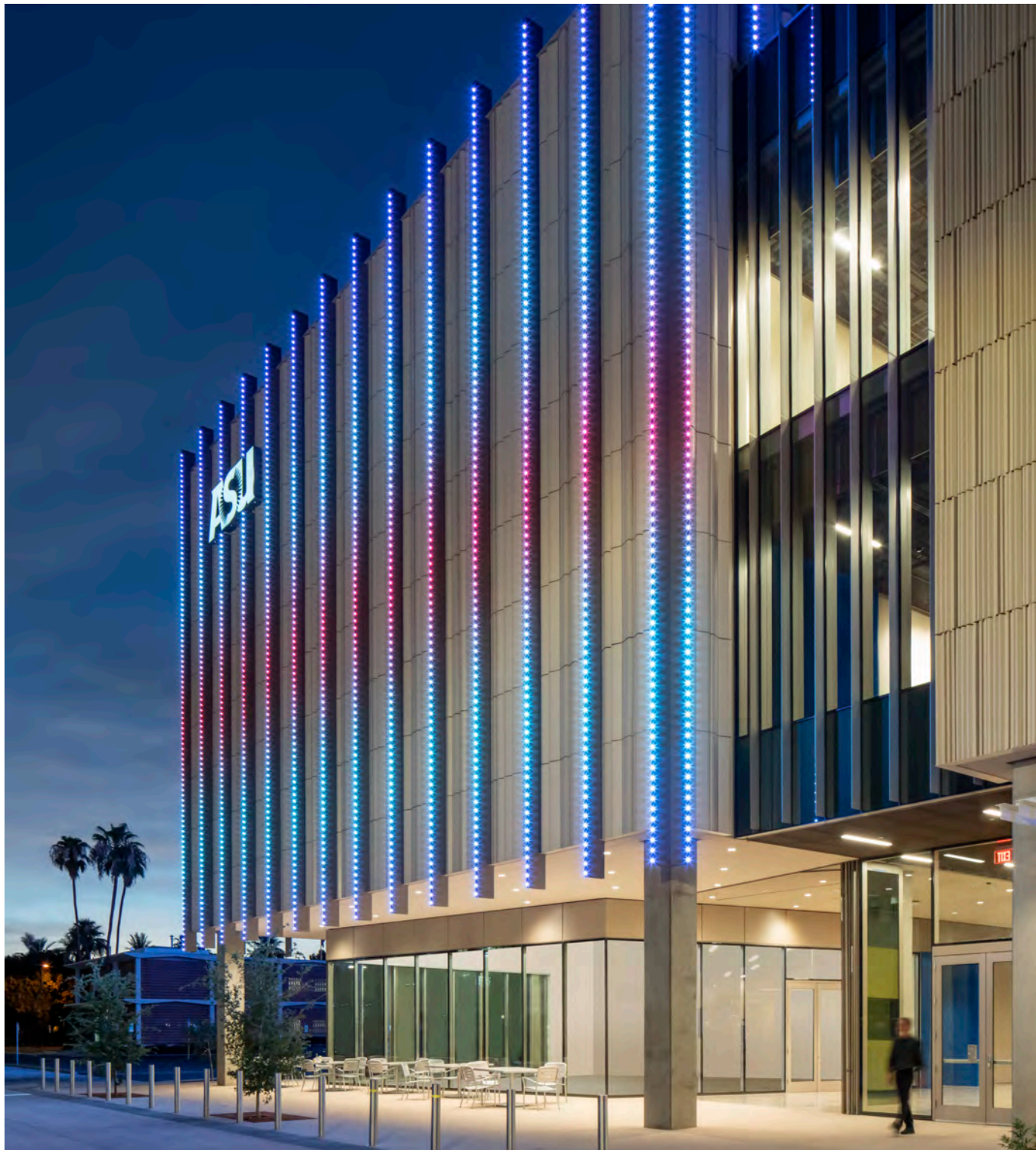

The Arizona State University MIX Center at Mesa City Center is a three-story, 118,000 square-foot academic building, that houses programs related to digital and sensory technology, media arts, film production and entrepreneurial development. Designed by co-architects Bohlin Cywinski Jackson and Holly Street Studio, with DPR Construction as general contractor, the new building opened to more than 750 students and faculty for the Fall 2022 semester.

Located in the heart of Mesa's Innovation District, the center serves more than 800 students who will be designing new virtual worlds and creating immersive media experiences.





The project includes a 2300-sq. ft. enhanced immersion studio, four sound stages, a 285-seat screening theater and an 80-seat screening room. The building also contains high-tech sound-recording studios, control rooms, display areas, editing rooms, classrooms, a fabrication lab, and office-support spaces, as well as a 30'x70' high-resolution LED screen on the exterior of the building.

The facility will serve as a laboratory for advanced media technologies, a platform for game development and a driving force for entrepreneurial solutions.

SAS worked closely with the project team, providing an expanded metal mesh feature ceiling around the building's central staircase. The ceiling design was delivered using the SAS205 double hook concealed grid ceiling system, finished in a custom color to RAL1035 and complimented by color matched architectural metal bulkheads closing of the ceiling membrane around the slab edges.





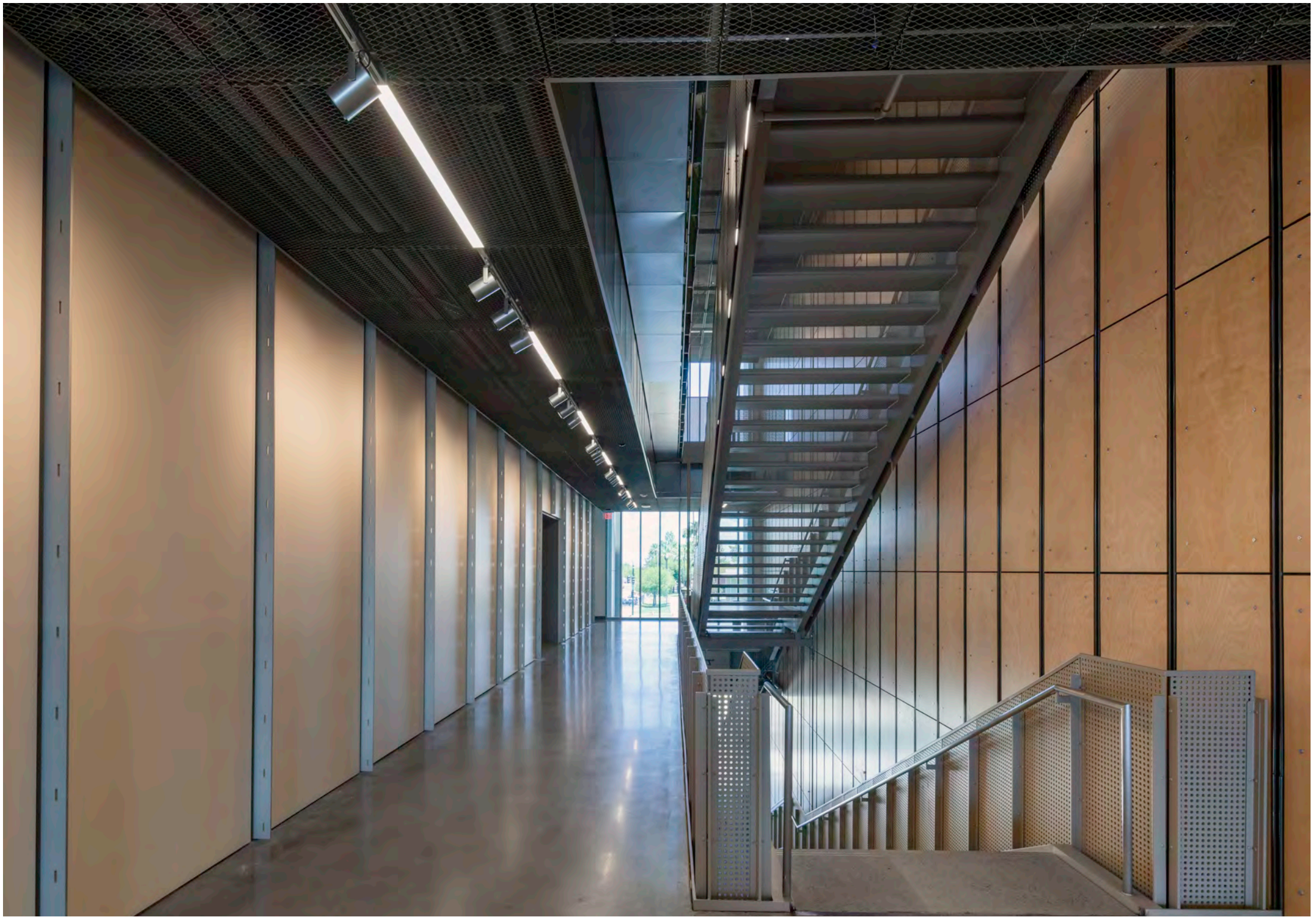

The expanded metal mesh feature ceiling continues outside of the building envelope, and above the main entrances, thereby providing continuity to the architect's design. The external ceilings were designed using a matching aluminum mesh and incorporating requirements specific to an external application such as fixing method and the integration of insect mesh.



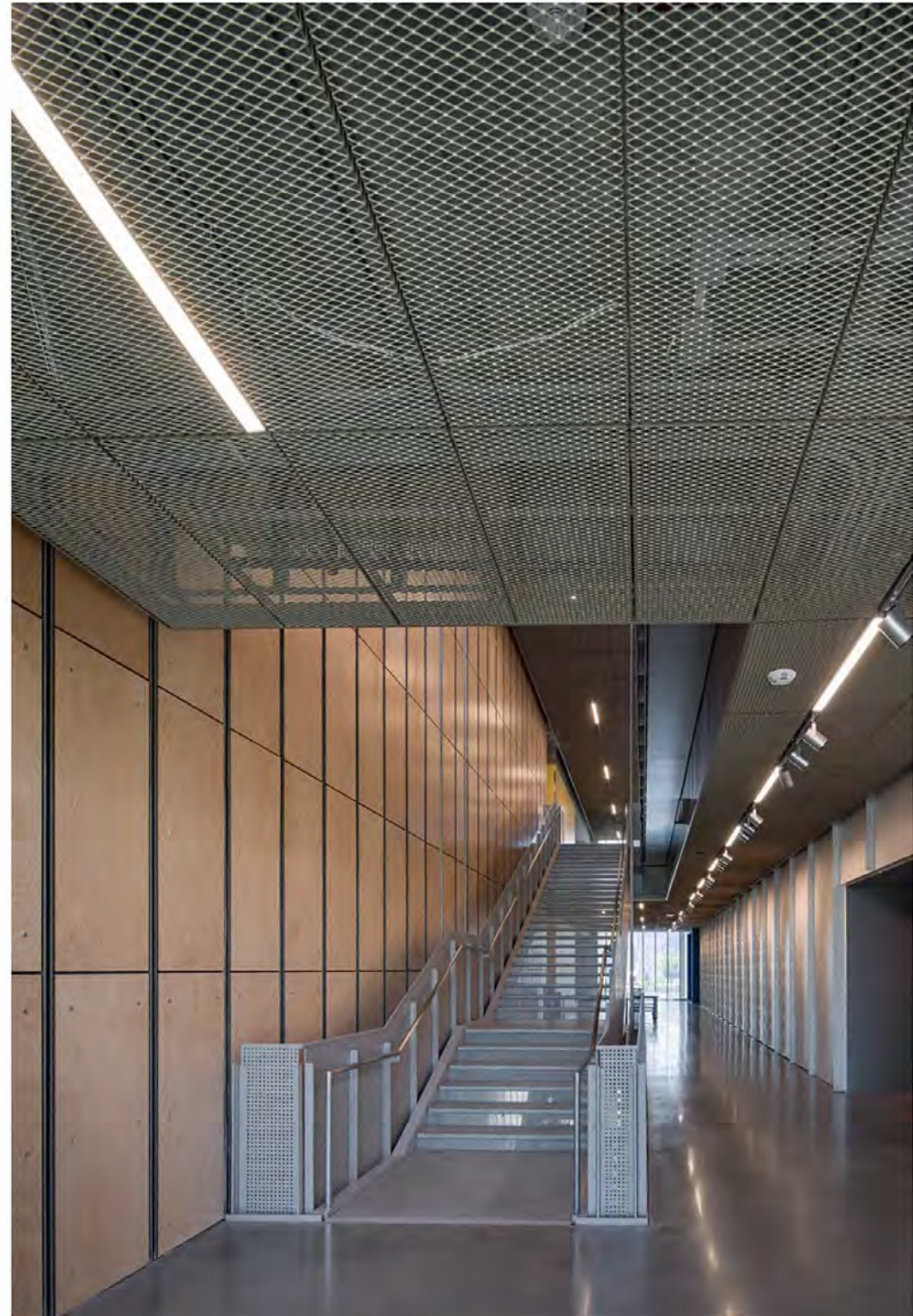

Arizona State University - CASE STUDY



SAS International is a leading British manufacturer of quality metal ceilings and custom architectural metal work for over 50 years.

Installed in iconic, landmark buildings worldwide, SAS leads through innovation, cutting-edge design and technical acoustic expertise.

Success is build on continued investment in manufacturing and achieving value for clients through world-class engineered solutions.

New York

60 East 42nd Street
Suite 1255
New York, NY 10165

sasint.us
info@sasint.us
+1 646 989 2672

Project Information

<i>Client:</i>	Arizona State University
<i>Architect:</i>	Holly Street Studio/Bohlin Cywinsky Jackson
<i>Location:</i>	Mesa, Arizona
<i>General Contractor:</i>	DPR Construction
<i>Installer:</i>	E&K of Phoenix
<i>Products:</i>	SAS205 DH Expanded metal mesh ceilings in RAL1033, color matched architectural metalwork bulkheads.
<i>Completed:</i>	2022

Contact us for more details